

# Madison - Kipp Meeting 2016

Name	org/title	email
① John Steketee	EPA, Region 5	steketee.john@epa.gov
Tom Dawson	WIS DOJ	dawson.tj@doj.state.wi.us
Mike Ribordy	USEPA R5	ribordy.mike@epa.gov
Jessica Kramer	WIS DNR	jessica.kramer@wisconsin.gov
Linda Hanefeld	WIS DNR	Linda.hanefeld@wisconsin.gov
Peter Ramanauskas	EPA, R5	ramanauskas.peter@epa.gov
Alina Satkarki	MCC	asatkarki@madison-kipp.com
Michael Harris	EPA, Region 5	harris.michael@epa.gov
Margaret Guerniero	EPA	guerniero.margaret@epa.gov
PATRICK HAMBUN	EPA, R5	HAMBUN.PATRICK@EPA.GOV
TONY KOBUNSKI	MCC	TKOBUNSKI@MADISONKIPP.COM
Dave CRASS	MS/MCC	dacrass@michaelbeef.com
Ken Zolnierczyk	EPA	zolnierczyk.kenneth@epa.gov

Name	org/title	email
① John Steketee	EPA, Region 5	steketee.john@epa.gov
Tom Dawson	WIS DOJ	dawson.tj@doj.state.wi.us
Mike Ribordy	USEPA R5	ribordy.mike@epa.gov
Jessica Kramer	WIS DNR	jessica.kramer@wisconsin.gov
Linda Hanefeld	WIS DNR	Linda.hanefeld@wisconsin.gov
Pete Ramaneuskas	EPA, R5	ramaneuskas.pete@epa.gov
Alina Satkaski	MCC	asatkoski@madison-tippc
Michael Harris	EPA, Region 5	harris.michael@epa.gov
Margaret Guerrino	EPA	guerrino.margaret@epa.gov
PATRICK HAMBUN	EPA, R5	HAMBUN.PATRICK@EPA.GOV
TONY KOZUNSKI	MCC	TKOZUNSKI@MADISONKUP.CO
DAVE CRASS	MS/MCC	dacrass@michaelbest.com
Ken Zolnierczyk	EPA	zolnierczyk.kenneth@epa.gov

## Summary of Environmental Cleanup Activities 2014 - 2016

### 2014

#### PCB Interior Investigation

- Advanced and sampled 27 soil borings within the building to complete delineation of VOCs and PCBs
- Excavation of center aisle to four feet

#### Rain Garden/Bike Path

- excavation, disposal and backfill of rain garden soils and
- adjacent parking lot soils

#### Groundwater

- Groundwater sampling in April, July and October
- In-Situ chemical oxidation (ISCO) injection of 5% sodium permanganate
- step test, permits secured and initiated construction of GETS

#### Vapor

- SVE operation
- vapor probe sampling

### 2015

#### PCB Interior Investigation

- wipe sampling
- indoor air sampling
- implementation of a PCB awareness program
- floor remediation activities
- groundwater investigation

#### Rain Garden/Bike Path

- Excavation, disposal and backfill of soils in rain garden and along capital city bike path

#### Groundwater

- Quarterly groundwater monitoring in accordance with groundwater monitoring program
- GETS operating as of July 2015

#### Vapor

- annual sampling of soil vapor probes
- operation of SVE

WI MRS20 FA Mechanisms.  
\$1.2M - Kipp established overtime. 2017 \$400K, then \$200K per yr.

## 2016

### Groundwater

- Quarterly groundwater monitoring in accordance with groundwater monitoring program
- GETS operation

### Vapor

- annual sampling of soil vapor probes
- operation of SVE

### Rain Garden/Bike Path

- Excavation, disposal and backfill of soils along capital city bike path
- Closure of rain/garden bike path activities in July 2016

### PCB Interior Investigation

- Completion of winter air sampling for PCBs

- 
- Cleanup level: open to Keg. Hydro<sub>2</sub>O (Dure). Used 50 g given remaining under cap external <sub>Sample</sub>
  - Filtered vs. unfiltered GW for final remedy.
  - Triggers for cleanup:

*PCBs Beneath the Madison-Kipp Facility*

PCBs have been present in the soils beneath the Madison-Kipp facility for nearly 50 years. The State and Madison-Kipp are discussing an iterative process to monitor and, if necessary, remediate soil beneath the facility if it is confirmed that PCBs have dissolved into and impacted groundwater. The parties have discussed the following concept:

- Annual sampling of two shallow wells within the facility’s footprint;
- If successive rounds of shallow sampling indicate that PCBs have dissolved into and impacted groundwater, Madison-Kipp will conduct quarterly sampling of the deeper zone of the two wells within the facility’s footprint and two additional wells to confirm whether PCBs have impacted groundwater;
- If there are successive rounds of sampling that confirm PCB impacts in these four wells, then Madison-Kipp would prepare a remedial action options analysis that would evaluate various remedial actions, including excavation of soil beneath the facility; and,
- Implementation of the selected remedy to address PCB-impacted soil beneath the facility.

In addition to this iterative process, Madison-Kipp would remove accessible impacted soil beneath the facility if:

- production operations cease or are altered such that contaminated soils can be reasonably accessed in any area of the manufacturing building; or
- the facility is sold or transferred, except to the extent that the facility is transferred as a going concern and the transferee continues the operation of the die casting machines.

Importantly, none of Madison-Kipp’s obligations under the settlement are altered by a sale or transfer, including the financial assurance mechanism remains in place. In the event of a sale or transfer, Madison-Kipp would provide the State with evidence that it has secured from the transferee the right of the DNR to access the facility and evidence of the transferee’s agreement to notify Madison-Kipp if production operations cease or are altered such that contaminated soils are reasonably accessible to allow Madison-Kipp to remove soil.

*Financial Assurance Mechanism*

To guarantee the performance of the above, the State and Madison-Kipp have discussed the following:

- Financial assurances in favor of the State in the amount of \$1.2M will be established;
- The form of financial assurance to be established will be consistent with the financial assurance options available in Wis. Admin. Code NR 520 and;
- Madison-Kipp would initially fund the financial assurances in the amount of \$400,000 by 2017, and then annual installments thereafter of \$200,000, such that the financial assurance would be fully funded by December 31, 2021.

In 2 weeks  
prop. Hx  
Tech call



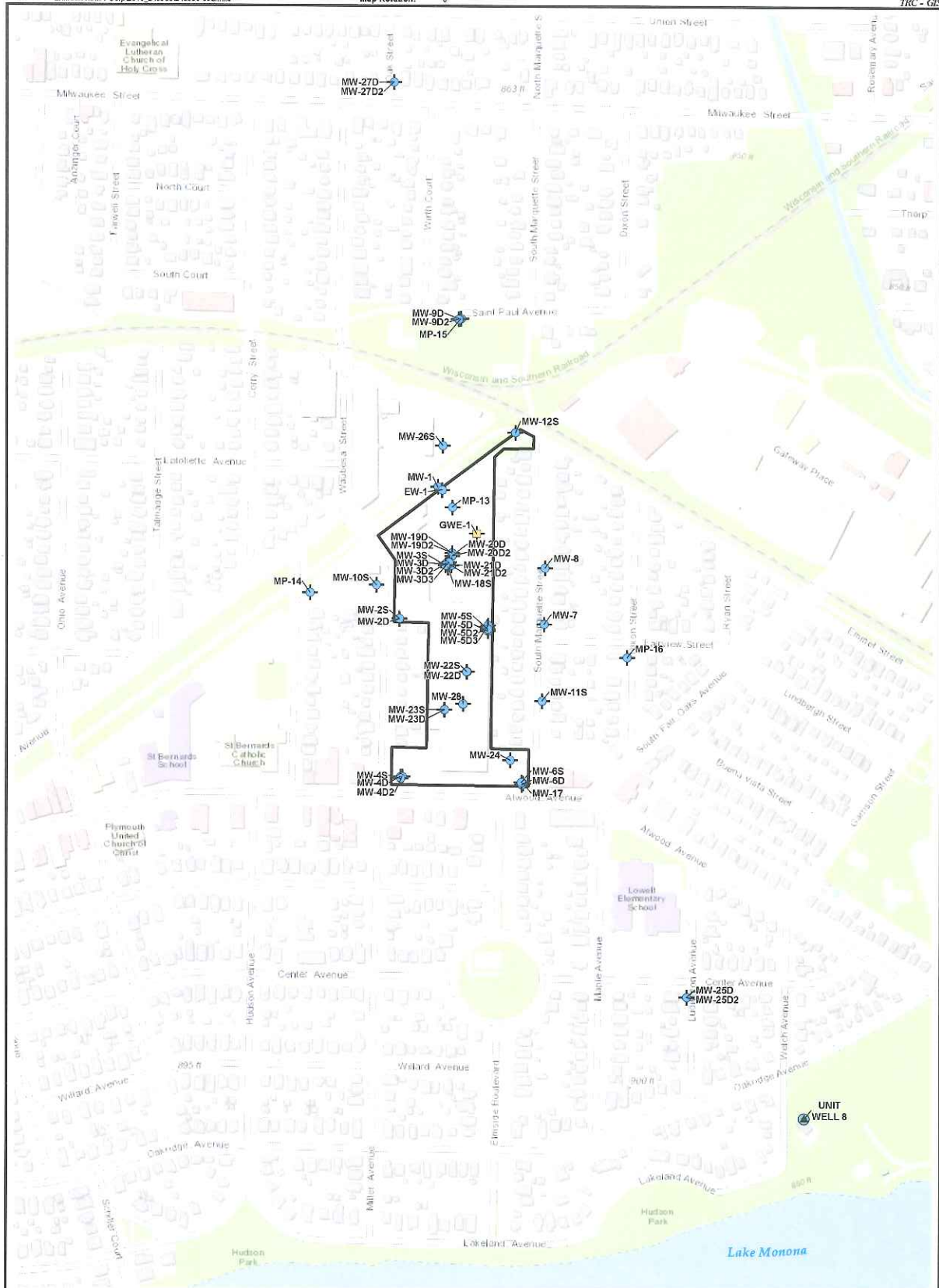

**LEGEND**

- SITE PROPERTY BOUNDARY
- GROUNDWATER EXTRACTION WELL
- MONITORING WELL
- MUNICIPAL SUPPLY WELL

BASE MAP FROM ESRI, "WORLD TOPOGRAPHIC MAP" WEB BASEMAP SERVICE LAYER.

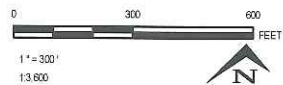

<p>708 Heartland Trail                  Suite 3000                  Madison, WI 53717                  Phone: 608.826.3600</p>	PROJECT	MADISON-KIPP CORPORATION 201 WAUBESA STREET MADISON, WISCONSIN	DRAWN BY: JPAPEZ CHECKED BY: A STEHN APPROVED BY: JRICE
	TITLE	WELL LOCATIONS MAP	DATE: SEPTEMBER 2016 PROJ. NO.: 243950 FILE: 243950-002.mxd
			<b>FIGURE 2</b>

